



How to hang a metal gate

Metal gates provide good security as well as adding to the appearance of your property.

Metpost gates are offered in varying widths and heights. A bespoke service is available through your stockist. Please ask for details.

Tools required:

- Tape measure
- Spirit level
- Power drill
- Masonry Bit

Fittings required:

Each gate will require one Metpost gate fittings pack (GTFIT). Each pack contains 2 hinges and a latch, plus all necessary fixings with the exception of wall plugs.

MEASURING FOR A METAL GATE

Measuring for metal gates differs from a timber gate in that the size quoted includes the fittings for the gate. When using metal posts these will also have to be added to the gate width. Measure the gap at top and bottom then select the size of gate required. Metpost Metal Gates come in 3 widths to fit the following gaps:

Gate Width:	To fit openings of:
770mm	825 – 900mm
810mm	900 – 975mm
840mm	900 – 975mm

Alternatively Metpost offer a made to measure service. Please ask your stockist for details.

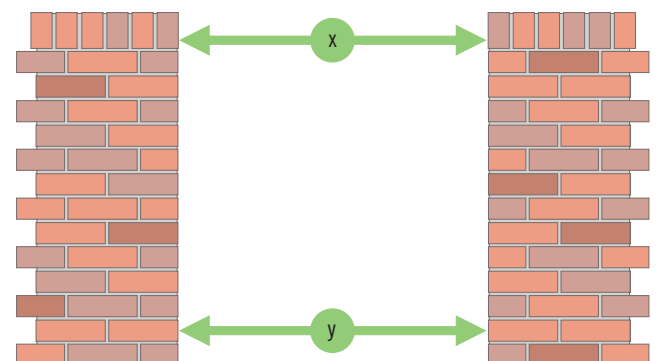

FITTING THE GATE

Raise the gate off the ground by approximately 50mm. Use two spacers for this and support in position. Use the holes in the gate to mark the wall where the gate is to be fixed (1).

The eyebolts used as the hinges are fixed on the top face of the wall brackets. When fixing the brackets to the wall, the face in contact with the eyebolt should be level with the points marked on the wall (2)

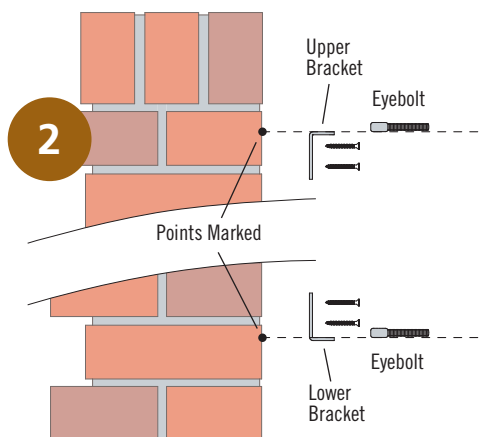
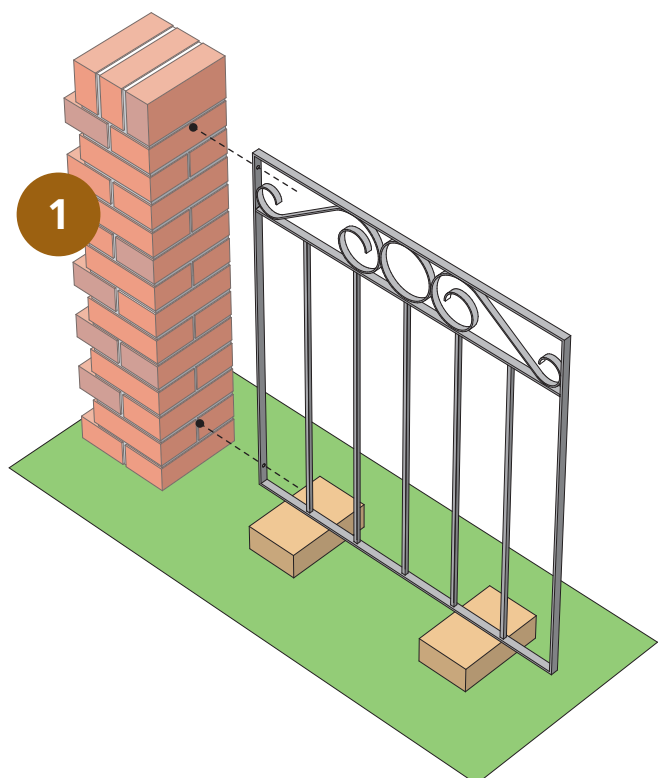

Fix the hinge brackets to the wall using the screws supplied in the fixing pack. If fitting the gate to metal posts, use the self-tapping screws supplied for this. Note the reverse orientation of the top and bottom brackets.

Fit the eyebolts to the gate and loosely tighten the nuts (3).

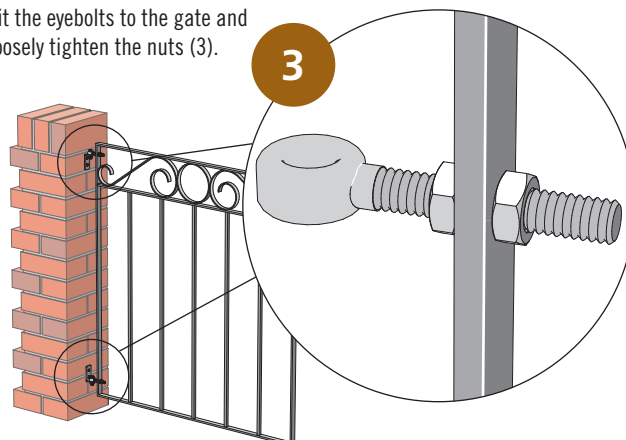

Hang the gate on the hinge brackets and level it up using the adjustment on the eyebolts.

Lock the nuts when you are happy that the gate is level and swinging freely.

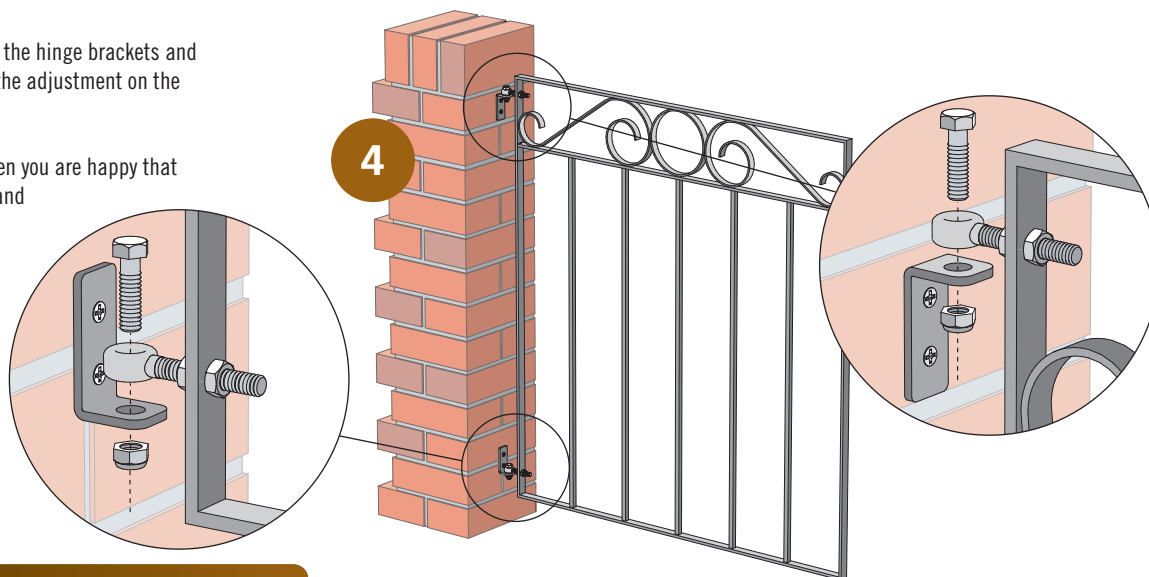

FITTING THE LATCH

Mark the position of the latch keep and fix to the wall using the screws supplied in the fittings pack (wall plugs are not included).

If fitting to metal posts (UNIPOST), use the 5mm self tapping screws supplied.

The latch can be used for left or right hand opening and is designed to allow the fitting of a padlock.

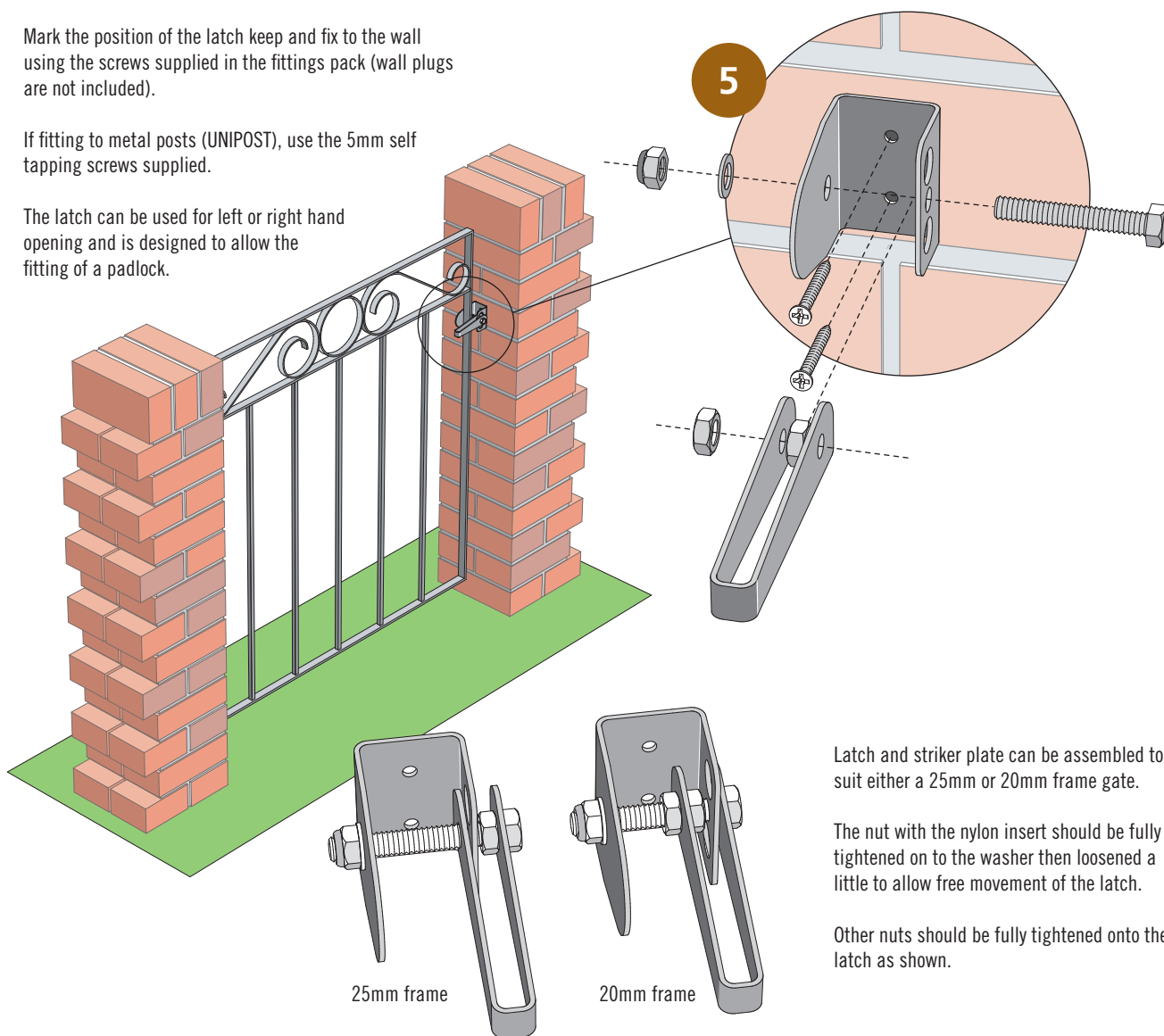

Latch and striker plate can be assembled to suit either a 25mm or 20mm frame gate.

The nut with the nylon insert should be fully tightened on to the washer then loosened a little to allow free movement of the latch.

Other nuts should be fully tightened onto the latch as shown.